

Design flooring, multilayer, modular, for floating installation

## EXPONA LIVING CLIC

Tiles  
304,8 x 609,6 mm

### 1. GENERAL INFORMATION

EXPONA LIVING CLIC is constructed of PVC over a rigid core to offer a strong, durable construction which is 100% waterproof\* and offers impressive acoustic performance. The tile size is 304.8 mm x 609.6 mm. The tiles are locked together without the need for any glue by a unique locking system to create a floating floor where the tiles can be installed and locked together in a single action. EXPONA LIVING CLIC incorporates an acoustic base and therefore requires no underlay. **To ensure the best finished appearance it is essential to follow these installation instructions carefully.**

### 2. PRIOR TO INSTALLATION

When installing EXPONA LIVING CLIC tiles always follow current national standards for the installation of floor coverings. Best current installation practice incorporating the latest technical developments should also be employed. The preparation of the subfloor, the installation of the floor covering and the measures taken to safeguard value are key factors in ensuring optimum suitability and performance of resilient floor coverings. On receipt of materials, check that the colours correspond to those ordered and that there is no damage or visual defects in the material. Check that the material is from one batch. Claims for visual defects can only be accepted prior to installation and cutting.

### 3. PREPARATION OF SUBFLOORS

Subfloors should be prepared as described in BS 8203 / DIN 18365 or prevailing local / national standards. EXPONA LIVING CLIC can be installed over most hard subfloors, provided they are prepared in accordance with local standards. Subfloors must be hard, clean, and free from contamination, dry, durable, flat and sound. Solid subfloors must be tested in accordance to local standards to ensure they are not damp. Carpets and soft floorings are unsuitable as a base for the installation of EXPONA LIVING CLIC, and will need to be removed prior to installation. Remove all debris and vacuum the whole subfloor area prior to commencing the installation. Where underfloor heating is used the maximum temperature on the surface of the flooring must never exceed 27 °C. Subfloors should be tested for moisture in accordance with local standards. Solid subfloors should demonstrate a maximum damp content of 75 % RH before the installation can begin.

Residual moisture content:

|           |         |                |
|-----------|---------|----------------|
| Cement    | without | UFH - 2 % CM   |
|           | with    | UFH - 1.8 % CM |
| Anhydrite | without | UFH - 0.5 % CM |
|           | with    | UFH - 0.3 % CM |

Remove any unevenness in the subfloor prior to installation. Subfloor levels should be in accordance with local national standards and in any event, should never exceed a maximum deviation of 5 mm when measured under a 3 m long straight edge. High spots and ridges should be removed to prevent damaging the tiles locking mechanism.

### 4. CONDITIONING

EXPONA LIVING CLIC must be protected against dirt and moisture during storage and both before and during the installation. The climatic conditions acceptable for the installation of EXPONA LIVING CLIC are:

|                   |         |
|-------------------|---------|
| Floor temperature | > 15 °C |
| Room temperature  | > 18 °C |

Prior to installation, open the boxes and place them in the room they are to be installed in for a minimum of 48 hours **BEFORE** the installation commences, so the material can acclimatise. Boxes should never be stacked greater than 3 high. **Ensure that the room temperatures are between 18 and 27 °C during the conditioning period. Shuffle the tiles to ensure a random appearance before installation.**

### 5. INSTALLATION

As EXPONA LIVING CLIC is a floating floor, a minimum expansion gap of 5 mm should be left around the entire installation perimeter and anything protruding from the subfloor such as radiator pipes, fixed down items etc. For larger installations over 5 m x 5 m an additional expansion gap of 1 mm per linear meter of room length should be used. For example, a room 8 m x 4 m would require an expansion gap of 8 mm around the entire perimeter of the room and around anything protruding from the floor. In areas under 5 m x 5 m use small offcuts as spacers between the tiles and the walls to help achieve the correct expansion gap size. Skirting boards should be removed and door frames / architraves undercut to allow for possible expansion. A suitable quadrant or scotia trim can be used to cover the expansion gap.

If installing in multiple rooms, finish the EXPONA LIVING CLIC tiles in the doorway on either side of the door to make separate floors. Allow a larger expansion gap between two such floors of double that left around the perimeter. Use two small offcut pieces of EXPONA LIVING CLIC placed back to back to gauge the correct expansion gap size at door thresholds. A suitable threshold strip can then be installed to cover the resultant gap. EXPONA LIVING CLIC should never be installed across multiple rooms as one floor. Tiles should always be laid with offset joints in a symmetrical brick bond pattern. When adjoining other floor coverings, finish the EXPONA LIVING CLIC in the doorway. An appropriate expansion gap should be left between the EXPONA LIVING CLIC and the adjoining floor covering. This can be covered using a suitable threshold or diminishing strip (see diagram below). Areas over 10 m x 10 m will require specialist advice. Please contact objectflor's Customer Technical Support.

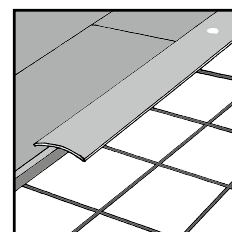

Fig. System profile

\* EXPONA LIVING CLIC tiles are 100% waterproof. Therefore they will not absorb water and the structural integrity of the product will not be affected by water e.g. no swelling. In the case of standing water or flooding, EXPONA LIVING CLIC will not act as a barrier between standing water/flooding and the subfloor, and as such is not recommended for continually wet areas such as walk in shower rooms.

Design flooring, multilayer, modular, for floating installation

## EXPONA LIVING CLIC

### Tiles

304,8 x 609,6 mm

#### YOU WILL NEED:

- Pencil
- Utility knife
- Retractable measuring tape or folding ruler
- Handsaw / Hacksaw
- Carpenter's 90° square
- Steel ruler, pull bar, spacer

The use of safety glasses and protective gloves should also be considered.

#### a. First tile first row:

The tiles are laid without glue. Start to lay the floor in the left-hand corner of the room with the lower male profile facing towards you (Fig. 1). A minimum expansion gap of 5 mm should be left around the installation perimeter and anything protruding from the subfloor. Use small offcuts from the tiles as spacers between the tiles and the walls to help achieve the correct size gap.

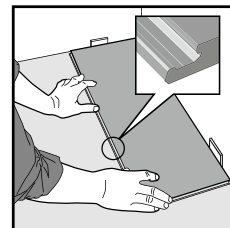

Fig. 1

#### b. Second tile first row:

Align the short end of the second tile close to the corresponding short end of the previous tile. Carefully fold it down with a single action movement (Fig. 2). Press firmly down on the short end of the next tile into the corresponding short edge of the first one, (Fig. 3). These should now lock securely together. It is important to ensure early in the installation that the short joints are fully engaged and locked into one another. Provided the tiles align and fit flush with each other on the short joints after any hand pressure has been released, then the joints will be fully engaged. If they do not reapply pressure until this is achieved. Complete the first row in the same way (Continue in this way to as far as full tiles can be installed to the end of this first row). Note – if any tiles require disassembly, the short sides can only be separated when flat on the floor, secure one tile and slide the second tile towards you.

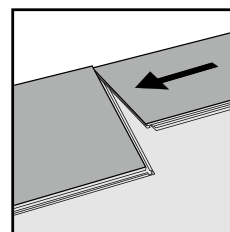

Fig. 2

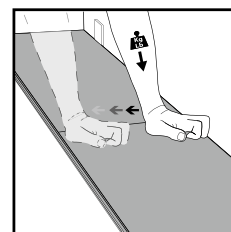

Fig. 3

#### c. Last tile first row:

Insert correct sized spacer between the end of the first row and the wall to ensure the correct expansion gap is set. Before cutting this last tile first turn it around through 180° so the overhanging male profile on the short edge is facing the spacer / wall. This will ensure you have the correct profile required when positioning. Measure the length of this tile to fit (Fig. 4), cut to correct length.

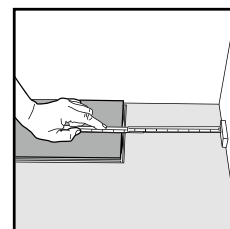

Fig. 4

#### d. First tile second row:

The tiles should only be installed in a symmetrical brick pattern (Fig. 5), cut a new tile in half and use this to start this row (Fig. 6). Do not forget to insert a spacer to provide the required expansion gap to the wall. At a slight angle, insert the upper male profile of the long side of the tile into the corresponding lower profile of the long edge of the tile in the previous row, press down until it locks into place.

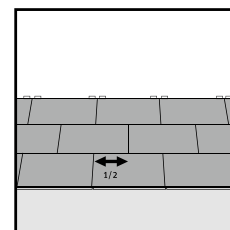

Fig. 5

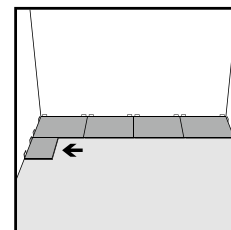

Fig. 6

#### e. Second tile second row:

Gently place the tile close to the short end of the previous one. At a slight angle, insert the upper male profile of the long side of the tile into the corresponding lower profile of the long edge of the tile in the previous row. Fold it down in a single action movement ensuring the corner of the long and short sides connect into the corresponding profiles of the short edge of the first tile second row. (Fig. 7) Press down and firmly to lock into place.

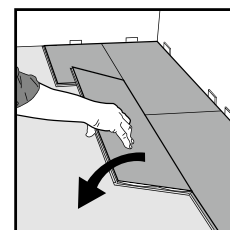

Fig. 7

Design flooring, multilayer, modular, for floating installation

## EXPONA LIVING CLIC

Tiles  
304,8 x 609,6 mm

### f. Remaining rows:

Fit subsequent tiles into place in the same way by easing the upper and lower profiles together on the long edges taking care to gently press down on the short joints until they lock into place. Remember to place spacers to ensure the correct expansion gap has been left at the walls (Fig. 8). Continue in this way to the last row.

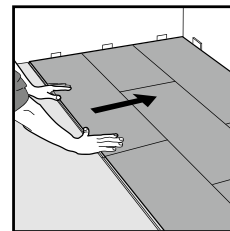

Fig. 8

### g. Last row:

To cut the tiles to fit the last row, position them one at a time directly over the previous row in the direction you will be laying them. Lay these tiles on top of the installed row (Fig. 9). Hold them firmly in place. Then line up a third tile on top. Place the edge of this tile against the wall after inserting a spacer. Use the edge of this tile to mark the cutting line with a pencil on the tile beneath (minimum width 50 mm). Carefully scribe along this line with the utility knife. Remember to place a spacer to the wall before measuring to ensure the correct expansion gap is left. After scribing cut the tiles lengthwise. Remember to allow for the expansion gap. Carefully cut any excess with either a saw or a sharp utility knife. If needed a pull bar can be used to pull the tile of the last row into the corresponding profiles of the penultimate row.

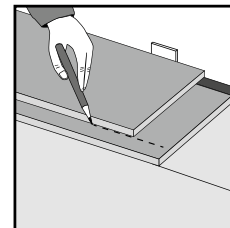

Fig. 9

### h. Radiator pipes:

Mark the centres of the holes on both the long and short sides using a carpenter's square and a pencil. Where the marks cross, drill a pilot hole using a thin #6 or #8 drill bit. Further drill the hole with a spade bit wide enough to accommodate both the diameter of the pipe and the required expansion gap. Cut around as shown with a saw or with a sharp utility knife (Fig. 10). Install the floor tile. If necessary, put a bead of contact glue on the cut piece and replace. Insert a spacer directly behind the inserted piece to wedge it in place ensuring that the correct sized expansion gap has been left. Leave this in place until the glue has hardened (Fig. 11).

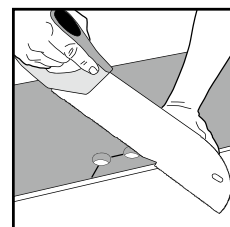

Fig. 10

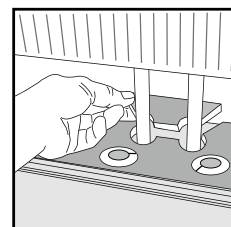

Fig. 11

### i. Door frames / Architraves:

When installing EXPONA LIVING CLIC around a door frame or architrave cut into the door frame / architrave with a handsaw, using an offcut tile as a guide for the height and the amount to trim off the door frame (Fig. 12). Slide the cut piece under the door frame (Fig. 12). Slide the cut piece under the door frame.

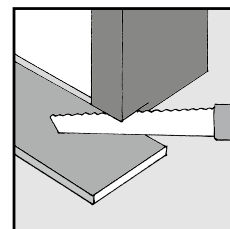

Fig. 12

### j. Dismantling tiles

Separate the whole row by carefully lifting up and release the whole row (Fig. 13). Disassemble the tiles by sliding the short ends horizontally (Fig. 14).

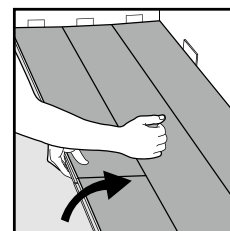

Fig. 13

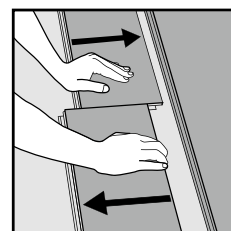

Fig. 14

Because EXPONA LIVING CLIC is a floating floor, it can be walked on straight away after it has been installed. Remember to take out any offcuts or spacers you have used to gauge the expansion gap around the perimeter. Skirting boards, base boards, quadrants or scotia can be used to conceal the expansion gap; however they should be fitted directly to the wall or skirting board and never directly onto the surface of the product. Leave a small gap between the two (2 mm) to allow for free movement of the tile. Do not use mastic or sealant to fill this gap.

## 6. NOTES

EXPONA LIVING CLIC is a loose lay product. In areas subject to large temperature fluctuations such as heavily glazed areas and areas subject to direct sunlight, special care must be taken including a larger expansion gap of a minimum 10 mm and adequate UV protection.

**Please contact our objectflor Customer Technical Support.**